

THIS DRAWING AS AN INSTRUMENT OF SERVICE SHALL NOT BE REPRODUCED, ALTERED OR REUSED IN WHOLE OR IN PART WITHOUT THE WRITTEN PERMISSION OF THE ARCHITECT. ARCHITECTURAL DRAWINGS ARE PROTECTED BY THE U.S. GOVERNMENT COPYRIGHT LEGISLATION/COPYRIGHT 2006, W. BARRY AGNEW ARCHITECT, INC. ALL RIGHTS RESERVED.

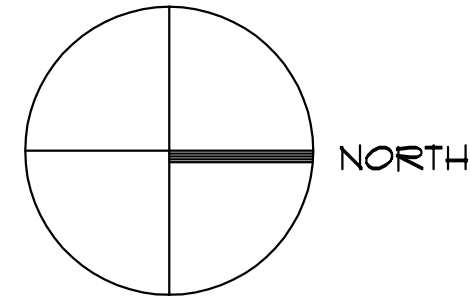

**DRAWING NOTES**

1. ALL DIMENSIONS ARE TO FACE OF WOOD STUD OR TO CENTERLINE OF WOOD STUD UNO.
2. ALL STUDS - #2 KILN DRIED S.P.F. WOOD STUDS UNLESS NOTED OTHERWISE.

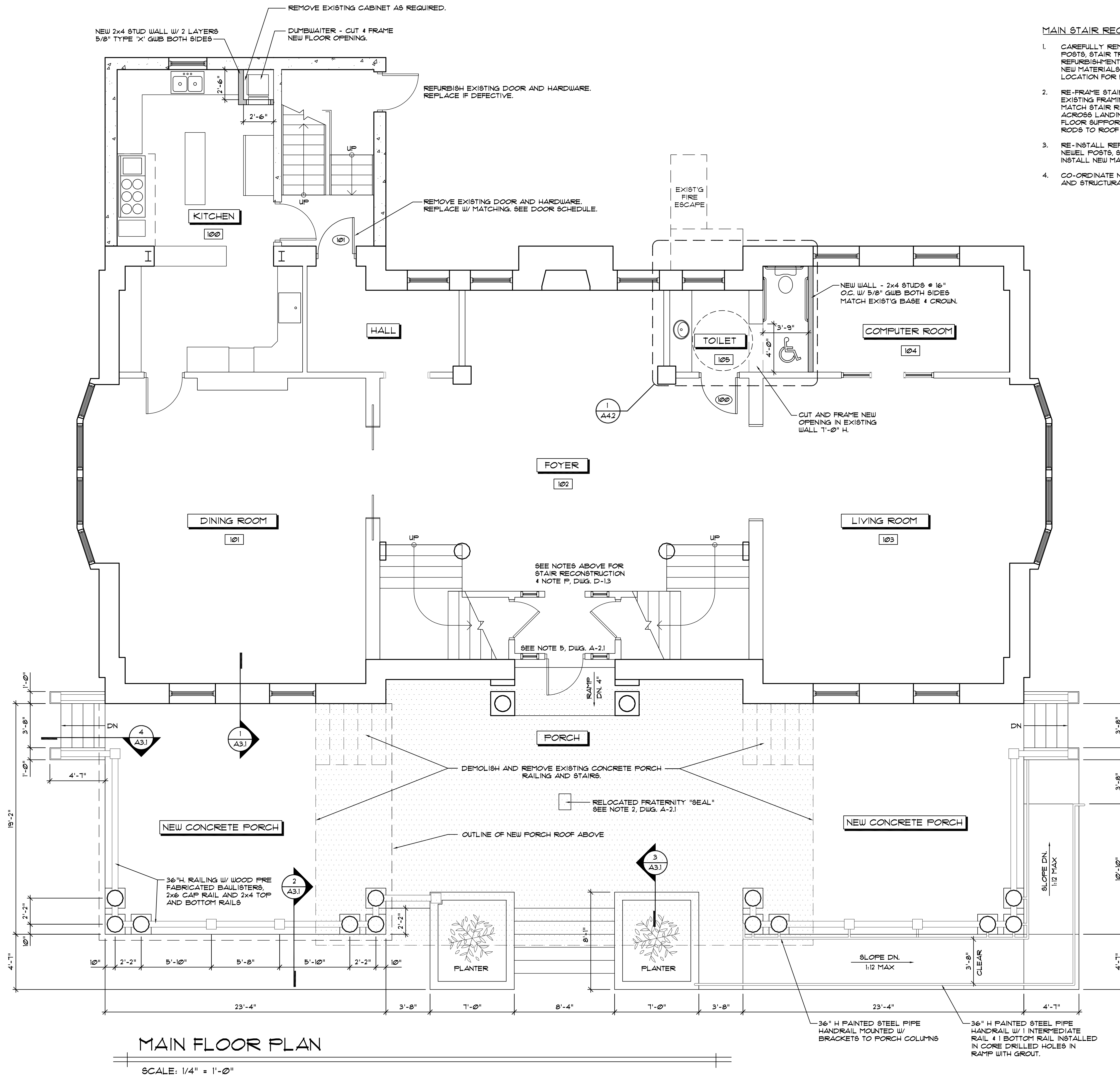

**MAIN STAIR RECONSTRUCTION NOTES:**

1. CAREFULLY REMOVE HANDRAILS, BAULISTERS, NEWEL POSTS, STAIR TREADS, RISERS AND TRIM FOR REFURBISHMENT AND RE-USE OR AS TEMPLATES FOR NEW MATERIALS. NUMBER COMPONENTS IN A HIDDEN LOCATION FOR PROPER RE-ASSEMBLY.
2. RE-FRAME STAIRS WITH NEW MATERIALS OR RE-USE EXISTING FRAMING TO LEVEL STAIRS AND LANDINGS. MATCH STAIR RISE AND RUNS. INSTALL NEW BEAM ACROSS LANDING BETWEEN SECOND AND THIRD FLOOR SUPPORTED BY SIDE WALLS IF SUPPORT RODS TO ROOF STRUCTURE CANNOT BE TIGHTENED.
3. RE-INSTALL REFURBISHED HANDRAILS, BAULISTERS, NEWEL POSTS, STAIR TREADS, RISERS AND TRIM OR INSTALL NEW MATERIALS TO MATCH ORIGINALS.
4. CO-ORDINATE NEW STAIR FRAMING WITH ARCHITECT AND STRUCTURAL ENGINEER AS NECESSARY.

W. BARRY AGNEW ARCHITECT, INC. 121 MANLY STREET, GREENVILLE, SC 29601 864-242-2514

**PHI KAPPA PSI FRATERNITY**

LAFAYETTE COLLEGE  
EASTON, PENNSYLVANIA

DRAWN BY:	EMK
CHECKED:	FJR
SCALE:	AS NOTED
JOB NUMBER:	0618
REVISIONS:	
APPROVAL:	4/12/06
OWNER REVIEW:	4/24/06
FINAL REVIEW:	5/22/06

CONSTRUCTION: -

DESCRIPTION  
MAIN FLOOR PLAN

SHEET

A-1.2

OF SHEETS